

1

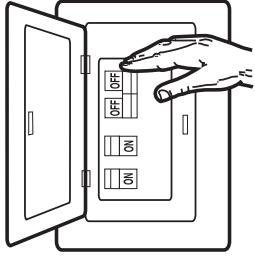

Turn power off
at circuit breaker box.

2

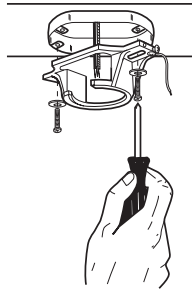

Install mounting bracket
to outlet box.

3

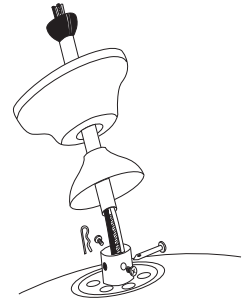

Attach downrod to
motor housing.

4

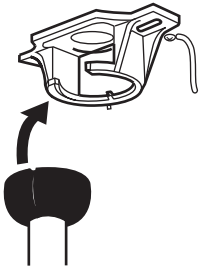

Install downrod in
mounting bracket.

5

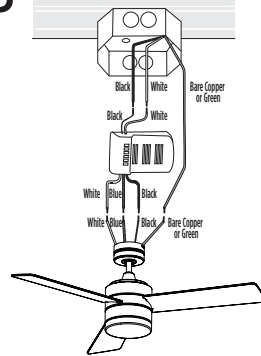

Make wire connection.
See instruction manual for
detailed wiring instructions.

6

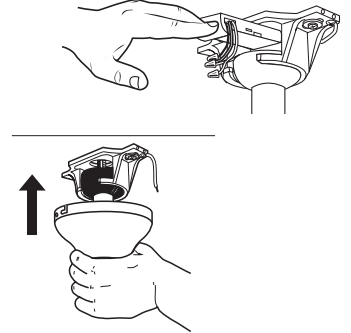

Install remote receiver
and raise canopy to ceiling.

7

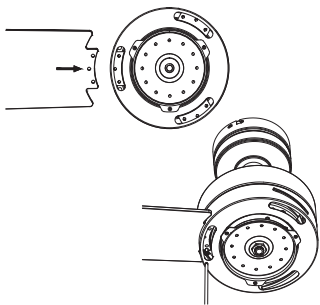

Install blades.

8

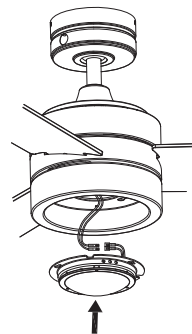

Plug in and install
light kit.

9

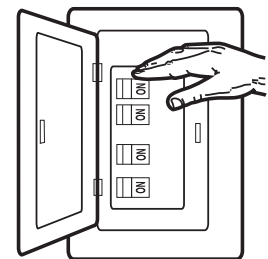

Turn power on
at circuit breaker box.

Prefer the more detailed installation instructions? We've got you covered. You'll find a comprehensive instruction booklet here in the box. You can also scan the QR code to access it online, along with more information about your fan.



WHO WE ARE

Westinghouse Lighting is a family-owned company with more than 70 years of experience in the lighting industry.

We believe exceptional lighting should also be accessible. Our goal is to deliver style and quality craftsmanship to suit a variety of preferences.

Our collection of ceiling fans and light fixtures range from classic designs to the latest on-trend styles. Our wide assortment of light bulbs provides the perfect finishing touch to any look.

Visit our website to see our complete collection of products.



THIS IS A SMART CEILING FAN



Connect to Wi-Fi and activate your fan to enjoy the following app-only feature:



Enjoy the feel of a gentle winds with the natural breeze feature.

"Alexa, Turn on my fan."

This fan is voice-activated*



*a smart speaker is required.

Control from anywhere with your smartphone



Download the Alexa app and get the most out of your ceiling fan.

GET IT ON Google Play

Download on the App Store



Step 1
Install the ceiling fan

Step 2
Download the Alexa app

Step 3
Activate your ceiling fan using step-by-step instructions in the app

Step 4
Enjoy!

Control your Westinghouse Smart Fan via voice through an Alexa enabled device!
See www.westinghouselighting.com/smart-ceiling-fans/alexa for a list of smart fans that works with Alexa.

Need help or have a question?
Live chat in the Alexa app is available for assistance.

